

## Description & Features

- Solid front blowout back for the ultimate in gauge safety
- Full rotary movement and micrometer pointer for ease in calibration

## Applications

- Used where operator safety is a must

## Specifications

### Dial Size

4.5"(115mm)

### Pressure Range

Vacuum to 0...20000 psi (1380 bar)

### Case Material

304 stainless steel case with solid front and blow out back

### Lens Material

4.5" (115mm): Tempered safety glass

### Ring Material

304 stainless steel with bayonet bezel

### Pointer

Aluminum black, micrometer adjustable

### Bourdon Tube

316L stainless steel

### Movement

Stainless steel

### Socket Material

316L stainless steel

### Connection

1/2" in NPT, BSP, BSPT / M20x1.5



### Protection

IP 65

### Ambient / Process Temperature

IP 65 dry: -40°C to 65°C

IP 65 glycerin filled: -10°C to 65°C

IP 65 silicone filled: -10°C to 120°C

### Working Pressure

Maximum 75% of full scale value

### Over-pressure

Standard 130% for full scale value

### Accuracy

±1.0% ANSI / ASME Grade 1A

### Options

Silicone filled

Monel tube and socket

Use no oil

Oxygen Cleaning

±0.5% accuracy

Stainless steel tag number plate

Calibration Certificate

Material Certificate

## Order Information

Series/ Dial Size/ Case Materials/ Wetted Parts/ Configuration/ Connection Size/ Thread/ Range/ Option

## Dimensions

### 4.5" Bottom Connection

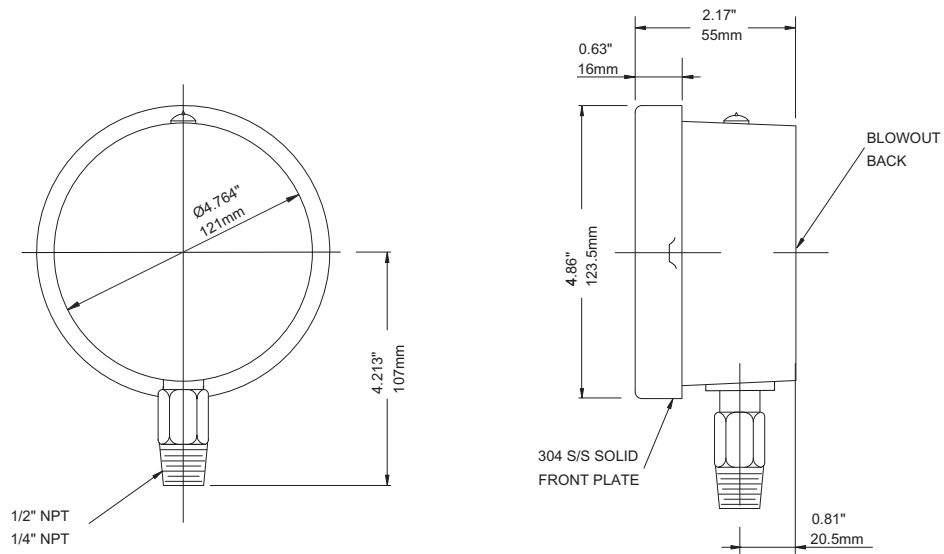

# PSC Safety Case Gauge

## Ordering Code PSC Series

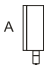
Field No.	Code	Specifications						
1.	PSC	Series						
<b>Dial Size</b>								
2.	45	4.5" (115mm)						
<b>Case Materials</b>								
3.	T	304 SS						
	S	316 SS						
<b>Wetted Parts</b>								
4.	S	316 SS						
	L	316L SS						
	M	Monel						
	Z	Special						
<b>Configuration</b>								
5.	A	Bottom connection, stem mounting						
	A							
<b>Connection</b>								
6.	2	1/2"						
	Z	Special						
<b>Thread</b>								
7.	N	NPT						
	B	BSP (G)						
	T	BSPT (R)						
	M	M20X1.5						
	Z	Special						
8.		Range (XXXX)						
<b>Standard Ranges</b>								
MPa	-0.1/0	-0.1/0.9	0/0.1	0/1	0/10	0/100		
	-0.1/0.06	-0.1/1.5	0/0.16	0/1.6	0/16			
	-0.1/0.15	-0.1/2.4	0/0.25	0/2.5	0/25			
	-0.1/0.3		0/0.4	0/4	0/40			
	-0.1/0.5		0/0.6	0/6	0/60			
bar	-1/0	-1/9			0/1	0/10	0/100	0/1000
	-1/0.6	-1/15			0/1.6	0/16	0/160	
	-1/1.5	-1/24			0/2.5	0/25	0/250	
	-1/3				0/4	0/40	0/400	
	-1/5				0/6	0/60	0/600	
psi	30"/0	30"/0/150	0/15	0/160	0/800	0/3000	0/10000	
	30"/0/15	30"/0/300	0/30	0/200	0/1000	0/4000	0/15000	
	30"/0/30		0/60	0/300	0/1500	0/5000	0/20000	
	30"/0/60		0/100	0/600	0/2000	0/6000		
	30"/0/100							
kg/cm <sup>2</sup>	-1/0	-1/9	0/1	0/10	0/100	0/1000		
	-1/0.6	-1/15	0/1.6	0/16	0/160			
	-1/1.5	-1/24	0/2.5	0/25	0/250			
	-1/3		0/4	0/40	0/400			
	-1/5		0/6	0/60	0/600			
kPa	-100/0	-100/900			0/100	0/1000		
	-100/60	-100/1500			0/160	0/1600		
	-100/150	-100/2400			0/250	0/2500		
	-100/300				0/400	0/4000		
	-100/500				0/600	0/6000		

Continued on the following page

Continued from the previous page

## Ordering Code PSC Series

Field No.	Code	Specifications
9.		<b>Options</b>
	SE	Glycerin filled
	SD	Silicone filled
	SY	Use no oil
	SL	Oxygen Cleaning
	SK	±0.5% accuracy
	SM	Stainless steel tag number plate
	SO	Calibration Certificate
	GH	Material Certificate